

AGENDA

FRIDAY, JANUARY 9, 2026		
Time	Session	
4:00 p.m. - 5:15 p.m.	General Session: Conclave Kickoff	Grand Salon II/III
5:25 p.m. - 6:45 p.m.	VP Track: Nuts and Bolts of Your Role VP of Administration VP of Programming VP of Finance	Marriott Ballroom Chicago E-H Chicago A-D
6:45 p.m. - 8:15 p.m.	Dinner	Grand Salon II/III
8:15 p.m. - 9:15 p.m.	Breakout: Understanding Your Beta Resources	See Nametag
9:15 p.m. - 10:00 p.m.	Focus Groups	Grand Salon II/III
9:15 p.m. - 11:00 p.m.	Beta Time	7th Floor Foyer and Grand Salon II/III
9:30 p.m. - 10:30 p.m.	Belonging and Wellness Focus Groups (By Invitation)	Chicago A-D
SATURDAY, JANUARY 10, 2026		
Time	Session	
7:30 a.m. - 8:45 a.m.	Breakfast	Grand Salon II/III
7:30 a.m. - 8:45 a.m.	Brighter Morrow Breakfast	Indiana/Iowa/Michigan/MI State
9:00 a.m. - 10:20 a.m.	VP Track: Introduction to Interpersonal Communication VP of Administration VP of Programming VP of Finance	Marriott Ballroom Chicago E-H Chicago A-D
10:30 a.m. - 11:30 a.m.	VP Track: Having Difficult Conversations VP of Administration VP of Programming VP of Finance	Marriott Ballroom Chicago E-H Chicago A-D
11:45 a.m. - 1:00 p.m.	Luncheon (Sponsored by the Beta Theta Pi Foundation)	Grand Salon II/III
1:00 p.m. - 2:30 p.m.	VP Track: Soliciting and Receiving Feedback VP of Administration VP of Programming VP of Finance	Marriott Ballroom Chicago E-H Chicago A-D
2:45 p.m. - 4:00 p.m.	General Session: Understanding the Beta Brotherhood Assessment	Grand Salon II/III
4:00 p.m. - 4:45 p.m.	Idea Sharing Snack Break	7th Floor Foyer
4:45 p.m. - 5:45 p.m.	VP Track: Accountability as a Leader VP of Administration VP of Programming VP of Finance	Marriott Ballroom Chicago E-H Chicago A-D
6:00 p.m. - 7:30 p.m.	General Session: Honoring the Process - Excellence in Initiation Ceremony Execution (Betas Only)	Grand Salon II/III
7:30 p.m. - 11:30 p.m.	Dinner and Exploratory Time	On Your Own
SUNDAY, JANUARY 11, 2026		
Time	Session	
7:30 a.m. - 8:45 a.m.	Breakfast	5th Flr Foyer, Chicago Ballroom
9:00 a.m. - 10:15 a.m.	General Session: Courageous Leadership	Grand Salon II/III
10:30 a.m. - 12:00 p.m.	Breakout: Establishing Strong Chapter Operations	See Nametag

TRACK LOCATIONS

KEY			
Letter	Location	Floor	Sessions
A	Grand Ballroom Salon II/III	7th Floor	General Sessions, Meals
B	Marriott Ballroom	4th Floor	Administration Track
C	Chicago A-D	5th Floor	Finance Track
D	Chicago E-H	5th Floor	Programming Track

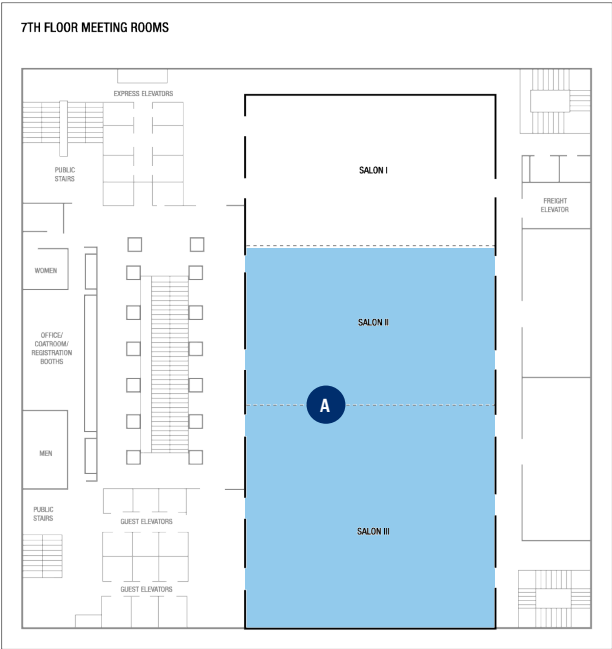
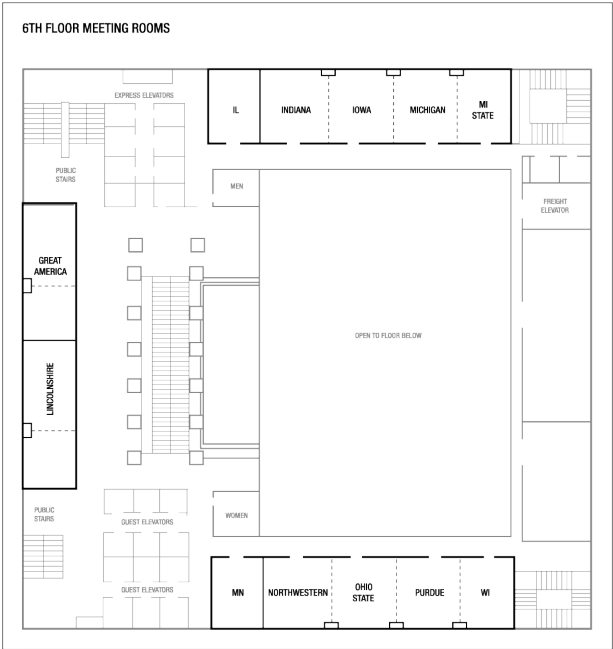
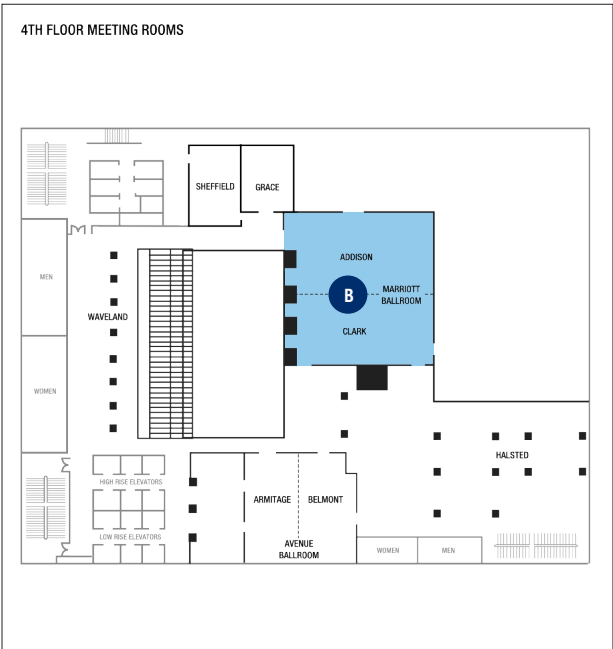

BREAKOUTS — LOCATIONS

NAMETAG LETTER KEY					
Letter	Location	Floor	Letter	Location	Floor
A	Avenue Ballroom	4th Floor	D	Chicago E-H	5th Floor
B	Marriott Ballroom	4th Floor	E	Chicago A-D	5th Floor
C	Grand Ballroom Salon I	7th Floor	F	Indiana/Iowa/Michigan/Michigan State	6th Floor

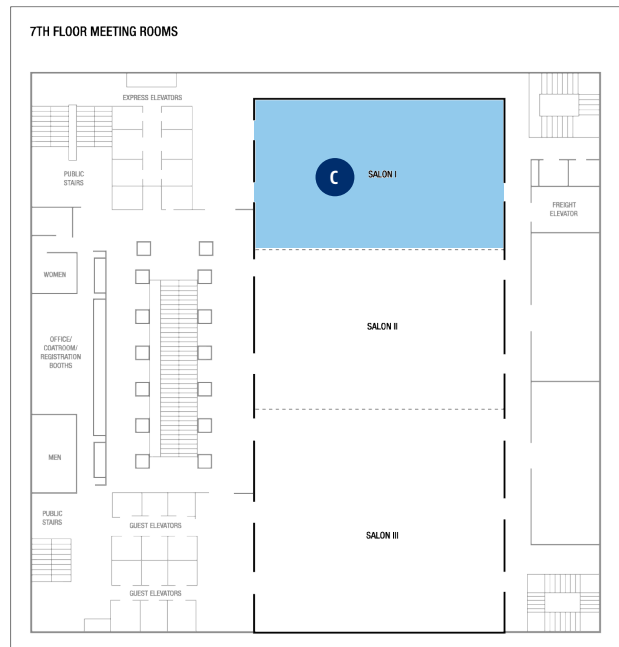
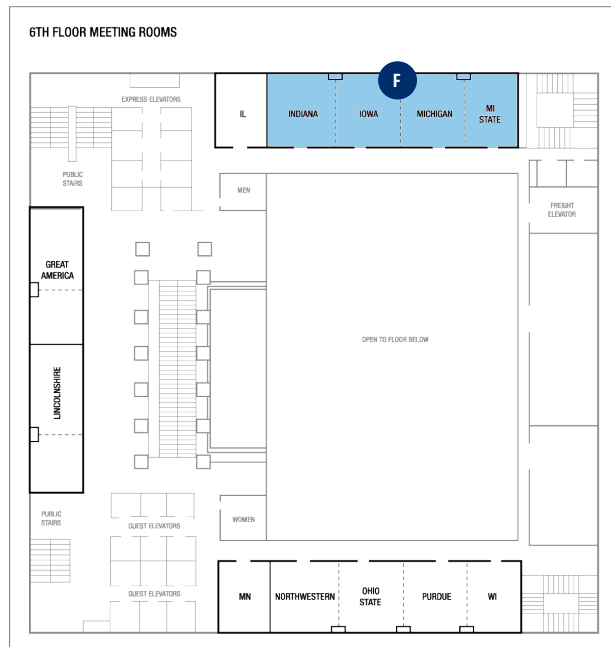
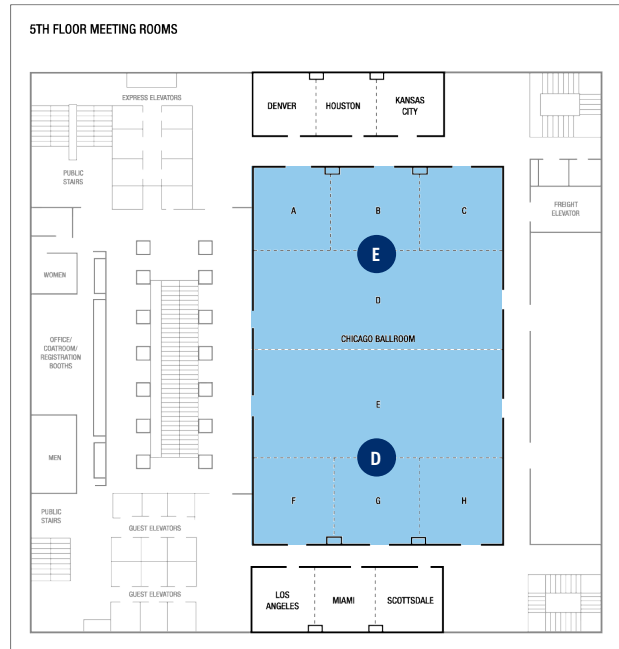

BREAKOUTS — BY CHAPTER

Chapter	Letter	Chapter	Letter	Chapter	Letter
Alabama	E	Idaho	B	Quinnipiac	B
Appalachian State	D	Illinois	D	Sacred Heart	B
Arizona	E	Indiana	D	Saint Louis	F
Arkansas	A	Iowa	D	Samford	E
Auburn	E	Iowa State	D	San Diego	E
Baylor	E	James Madison	C	San Diego State	E
Bethany	B	John Carroll	D	San Jose State	B
Boise State	B	Johns Hopkins	C	SMU	E
British Columbia	F	Kansas	E	South Carolina	B
Butler	D	Kansas State	E	South Dakota	D
Cal Poly	B	Kennesaw State	C	South Florida	B
Cal State, Chico	B	Kentucky	A	Southern California	E
Carleton	C	Kenyon	D	St. Lawrence	C
Case Western Reserve	D	Kettering A	A	Stevens	C
Central Florida	B	Kettering B	A	TCU	E
Central Michigan	A	Knox	D	Temple	F
Centre	A	Lawrence	D	Tennessee	E
Chapman	E	Louisville	A	Texas	E
Cincinnati	E	Loyola Marymount	E	Texas A&M	E
Clemson	B	LSU	A	Texas at Arlington	E
Colgate	C	Maine	C	Texas Tech	E
Colorado	F	Maryland	C	Toronto	C
Colorado Mines	F	Miami	E	Truman State	F
Colorado State	F	Miami (Fla.)	B	Tulane	A
Connecticut	F	Michigan State	A	UC Berkeley	B
Cornell	C	Minnesota	D	UC San Diego	E
Creighton	D	Mississippi	A	UCLA	E
Delaware	C	Mississippi State	A	Utah	F
Denison	B	Missouri	F	Vanderbilt	E
Denver	F	MIT	C	Villanova	C
DePauw	D	Nebraska	D	Virginia Tech	C
East Carolina	D	Nebraska at Omaha	D	Wabash	D
Eastern Kentucky	A	New Hampshire	C	Washington	F
Elon	D	New Jersey	C	Washington & Jefferson	B
Embry-Riddle	B	North Carolina	D	Washington in St. Louis	F
Emory	C	North Dakota	D	Washington State	B
Florida	B	Northeastern	C	West Chester	C
Florida Gulf Coast	B	Ohio	B	West Virginia	B
Florida State	B	Ohio State	B	Westminster	F
Furman	B	Oklahoma	A	Whitman	B
George Mason	C	Oklahoma State	A	Wichita State	E
George Washington	C	Oregon	F	William & Mary	C
Georgia	C	Pacific	B	Wisconsin	D
Georgia Tech	C	Pennsylvania	F	Wisconsin-Oshkosh	D
Hanover	A	Pittsburgh	B	Wittenberg	E
High Point	D	Purdue	D	WPI	C